



1. Product Name

2-Port Light Source

2. Product Code

21452

3. Colour

White exterior.

4. Brief Description

With all the key features of our standard light source, but with 2 ports so 2 fibre optic products can be operated from one light source and one electrical point.

5. Contents

- 1 x Light Source
- 1 x Power Supply Unit

6. Snoezelen® Stimulations

- Visual

7. Best Use

Use with Fibre Optics, Starcloths and Milky Way Carpets in a darkened environment.

8. Compatible ROMPA® Products

- Super Safe Plastic Fibre Optics 17903, 19869, 17905, 17907, 17908, 19870, 19871
- UV Fibre Optics 17557, 17558
- Jumbo Bamboo Fibre Optics 20473 20475
- Jumbo UV Bamboo Fibre Optics 20477, 20479
- Shimmering Curtain 20322
- Starcloths 17051, 17052
- Milky Way Carpet 11726, 14726

This unit is Wi Fi compatible, and will respond wirelessly to the following products:

- Talking Cubes 18870, 20402
- Colour Changing Panel 19214
- 8 Colour Wirefree Controller 19847
- Wi Fi Interactive Carpet Switch Set 19939
- Sensory Magic™ Touch Screen

When activated by a Wi Fi controller, the Rompa® Light Source automatically changes colour to that selected for 1 minute, before resuming automatic mode.

9. Starting Up

- Unpack and dispose of packaging appropriately and responsibly.
- Slide the boss of your Fibre Optics, Starcloth or Milky Way Carpet into the circular hole in the front face of the light source.
- Slide the boss in and out gently observing the different colour effects these will change from being mixed or a single colours.
- Experiment using a ROMPA® Wi-Fi controller select the desired effect.
- Tighten the screws on the top of the unit to secure the fibre optic products into the unit.
- Connect the Power Supply Unit and plug in at a wall socket.
- Using the ON/OFF switch at the back of the light source, switch the light source on

10. Detailed Description

With all the key features of our standard light source, but with 2 ports so 2 fibre optic products (e.g. Fibre Optic harnesses, Milky Way Carpets) can be operated from one light source and one electrical point. Especially useful in cushioned platforms where space is tight. Allows colour sequences of both products to run in tandem.

11. Safety

Always supervise the use of this product

- Only use the Power Supply Unit supplied with this light source. Do not connect any other power supply as this may damage the product.
- Use indoors, in dry environments.
- This product is not a toy.
- Remove all packaging and either store this in a safe place out of reach of clients or dispose of this responsibly. Plastic bags and wrapping can be hazardous to children and vulnerable people.
- Keep away from sources of heat and fire.
- Install the light source out of reach of clients.
- Allow unrestricted airflow around the light source. The ambient temperature should not exceed 40°C.
- Do not allow clients to pull on the Fibre Optics.
- Should you need to remove the Fibre Optics, remove the boss with care – release the screw – do not just pull these out with force.
- The light from the LEDs is very bright – do not look directly into the LEDs.
- Refer to and follow the safety instructions provided for your Fibre Optic harness.

12. Technical Specification

Weight (Including Power Supply Unit) 894g

Size of Lightsource (Not including Power Supply Unit) 177 x 84 x 60mm

Electrical spec (Power supply):

Input: 100-240Vac 50-60Hz 1.5A

Output: 12Vdc 5A

Approvals: CE, UL, CUL

13. Installation

- Remove all packaging from the 2-Port Light Source.
- Check product to ensure that it hasn't been damaged in transit. In the unlikely event that any problems are found, contact ROMPA® immediately
- Decide where to locate the 2-Port Light Source.
- Consider plug access. Check length of cable and ensure that where you choose to locate the 2-Port Light Source will not put strain on the cable, product, Power Supply Unit or plug.
- If using a shelf or bracket check these can comfortably hold the weight of the unit.
- The 2-Port Light Source has four predrilled holes to two sides to enable this to be secured down to a wall or other surface if this is required.
- Slide the bosses of your fibre optics, Starcloth or Milky Way Carpet into the circular holes in the front face of the light source.

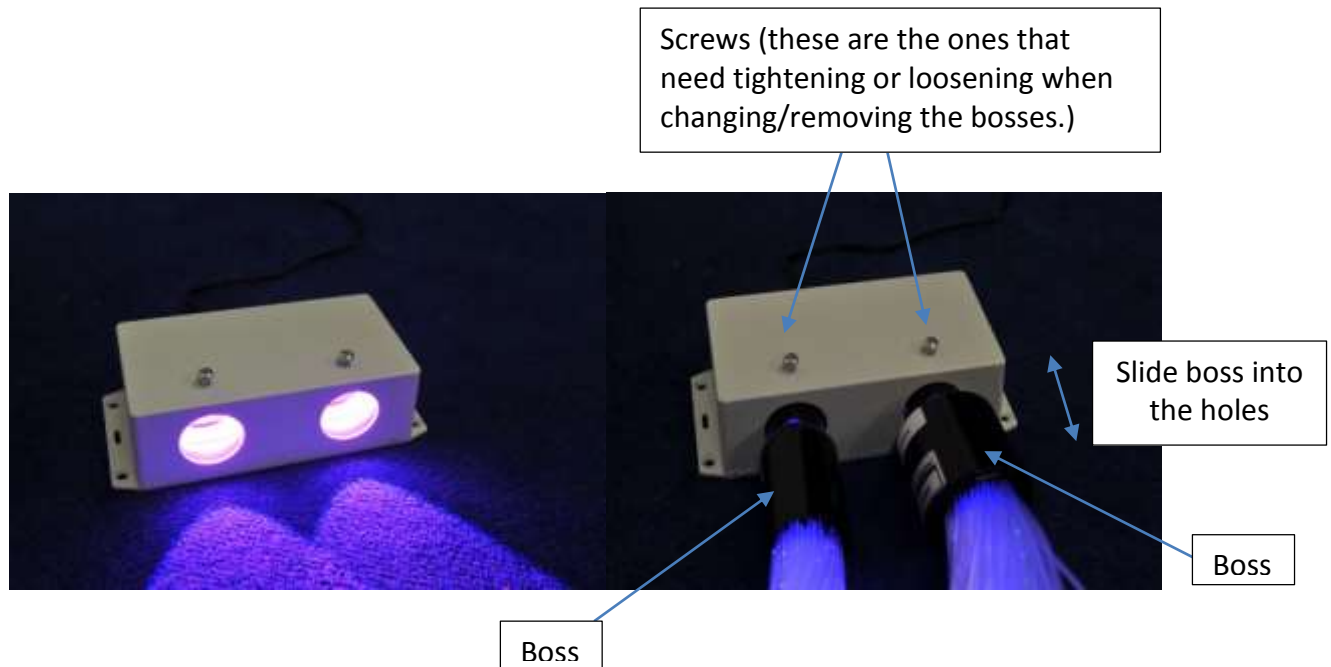

- Tighten the screws on the top of the unit to secure the items into the unit.
- Connect the Power Supply Unit. If the fit does not seem tight, 'wiggle' the lead into the light source, whilst pushing at the same time.
- Using the ON/OFF rocker switch at the back of the light source, switch the light source on.

14. Care and Maintenance

- Store out of reach of clients – do not allow unsupervised use.
- This 2-Port Light Source contains LEDs which typically last thousands of hours. Therefore it will not be necessary to change any bulbs.
- If removing your Fibre Optics etc., first unscrew the screw that secures these in place, do not just pull them out. This will cause damage to the unit.

15. Troubleshooting

In the unlikely event of product failure, please check the following:

Problem: No light

- Check that the Power Supply Unit connecting lead is pushed firmly into the light source
- Check the fuse that is in the Mains Power connector fitted to the back of the light source.
- Check the fuse in the plug (if UK plug fitted). This should be a 5A standard mains fuse.
- Remove any connection to the round black 5 pin socket on the back of the light source.
- Turn the light source OFF, wait 1 minute and then turn ON again.
- Problem: Insufficient Brightness from the Light Source

- Ensure that the Fibre Optic harness is pushed fully into the front of the light source. It will stop when it is fully pushed in. Tighten the top screw on the light port on the front of the Light Source to prevent the harness from being pulled out.

Problem: Light source sometimes changes colour randomly, and then goes back to its preprogrammed sequence.

- The Light Source may be picking up Wi Fi signals from somebody nearby who has a Colour Changing Panel or 8 Colour Wirefree Controller (or a Sensory Magic room).

Problem: Wi Fi signals from 2 different nearby rooms are interfering with each other.

- If you have 2 neighbouring rooms each using Wi Fi products, then the devices in both rooms can be controlled by any nearby Wi Fi controllers. An "All-In-One" Controller would be required to alter the wireless settings to operate without interfering with one another.

Further copies of these instructions can be downloaded at www.rompa.com

We hope you find our instructions invaluable. If you have any suggestions for improving them further your comments will be greatly received – please contact us at producthelp@rompa.com